

BENEFITS

The Coates Rollerboard™ Drive Thru Menu System has been developed with fast food equipment principles in mind and from our experience supplying the single and double rotating Drive Thru Menuboard since 1994. Our new three day part Rollerboard™ Drive Thru includes the following benefits:

- Fabricated steel inner support pole & base plate
- Hot dipped galvanised steelwork
- Aluminium hinged vertical side extrusions
- Clear UV protected polycarbonate panels virtually unbreakable (removable)
- Flexible acrylic translite dividers (repositionable)
- Key lockable aluminium extrusion curved doors
- Energy saving internal fluorescent tube illumination (2 tubes)
- Engineered reflector system to provide bright, even illumination
- Simple magnetic latch locking system for all three (3) sides
- Powder coated base, top, door & side extrusion in black
- Curved face design consistent with current directional, external & internal Rollerboard units
- Over 95% of existing 3 sided COD menuboard supplied by Coates for McOpco Restaurants

SPECIFICATIONS

The Coates Signco Rollerboard™ Drive Thru is available in following size:

2200mm high x 750mm (dia.) width 400mm high base with 1800mm high menuboard

Rollerboard™ Drive Thru has UV protected polycarbonate display faces which have a 10 year guarantee against weathering (excessive yellowing).

The Rollerboard™ units are electrically wired for 220v - 240v, 50Hz as standard. 110v wiring and or special electrical requirements are also available.

TRANSLITE SIZES

For best results we recommend satin finish translites to be used. The Coates Signco Rollerboard™ accommodates translite sizes:

Single: 555 x 555mm (21.85 x 21.85") allow +1mm -3mm tolerance

Double: 555 x 1150mm (21.85 x 45.276") allow +1mm -3mm tolerance

Preferred translite thickness is 0.3mm (0.0118")

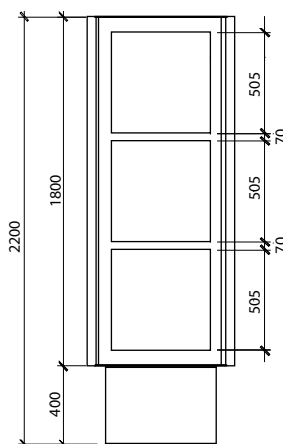

Front View

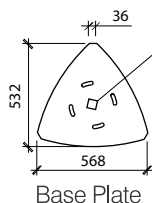

Central Access Point for Electrical connection

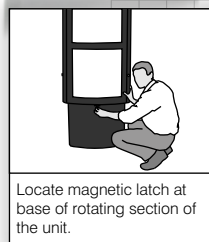

Locate magnetic latch at base of rotating section of the unit.

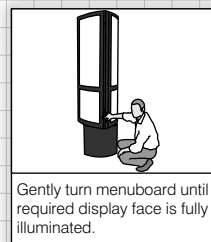

Gently turn menuboard until required display face is fully illuminated.

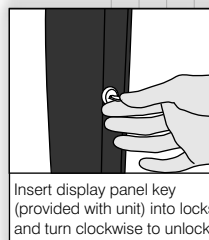

Insert display panel key (provided with unit) into locks and turn clockwise to unlock.

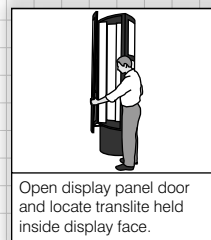

Open display panel door and locate translite held inside display face.

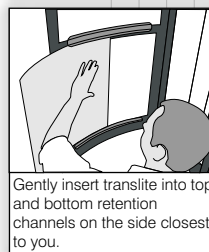

Gently insert translite into top and bottom retention channels on the side closest to you.

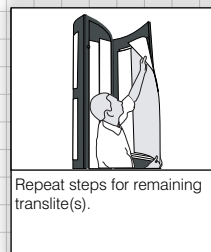

Repeat steps for remaining translite(s).



Coates Signco Pty Ltd
242 Young St Waterloo
NSW 2017 Australia
T +61 2 9699 3122
F +61 2 9698 2379
www.coatessignco.com
sales@coatessignco.com.au